

NOTES:

1. SUBSTRATE:
ZERODUR®

2. SURFACE S2 TO BE PARALLEL TO SURFACE S1 TO WITHIN 30 ARCSEC

3. COATING (APPLY ACROSS CLEAR APERTURE)
S1: R(abs) >99.5% @ 532 & 1064nm

DAMAGE THRESHOLD, BY DESIGN:
15 J/cm2 @ 20ns @ 532nm
20 J/cm2 @ 20ns @ 1064nm

S2: NONE

4. FINE GRIND SURFACE

5. POWER, IRREGULARITY, AND SURFACE QUALITY SPECIFICATIONS APPLY
ACROSS CLEAR APERTURE

6. CLEAR APERTURE AND COATING APERTURE ARE CENTERED ON SURFACES

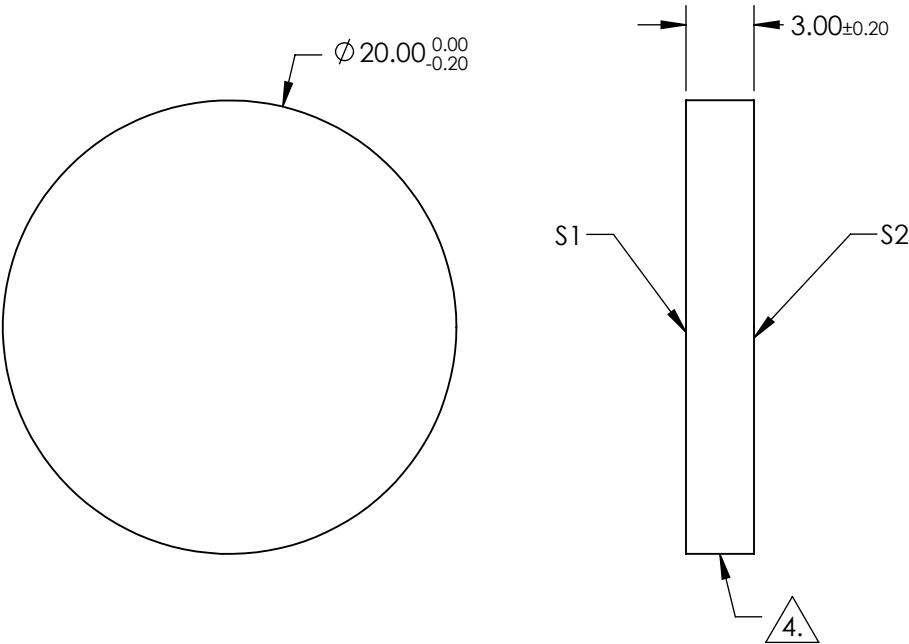
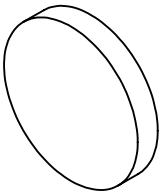

**FOR INFORMATION ONLY:
DO NOT MANUFACTURE
PARTS TO THIS DRAWING**

SPECIFICATIONS SUBJECT TO CHANGE WITHOUT NOTICE
DIMENSIONS ARE FOR REFERENCE ONLY

	S1	S2
SHAPE	PLANO	PLANO
SURFACE QUALITY	20 - 10	COMMERCIAL POLISH
SURFACE FLATNESS	$\lambda/10$	N/A
CLEAR APERTURE	Ø 18.00	N/A
COATING APERTURE	Ø 18.00	N/A
BEVEL	PROTECTED AS NEEDED	PROTECTED AS NEEDED

THIRD ANGLE PROJECTION	
ALL DIMS IN	mm

 Edmund Optics®			
TITLE		20.0mm Dia x 3mm 532/1064nm, Zerodur Dual Band Laser Mirror	
DWG NO		29058	SHEET 77 OF 86