

TECHSPEC® Cx SERIES FIXED FOCAL LENGTH LENS

QUICK START GUIDE

List of Parts Included:

- A. Front Assembly
- B. Main Housing with Locknut (Nylon Tip Screw Installed)
- C. Rear Assembly
- D. Socket Set Screw M3.0 x 0.5 x 2 (x3)
- E. Rear Lens Cap
- F. Front Lens Cap

Accessories (one required, not included):

- Aperture
- Filter Holder
(Holds unmounted filter: 12.5 mm diameter, 1.5 or 2.0mm thick)
- Liquid Lens Holder
(Holds Arctic A25H0 or 39N0)

WARNING: Liquid Lens ribbon is fragile. Use caution when assembling unit and during handling.

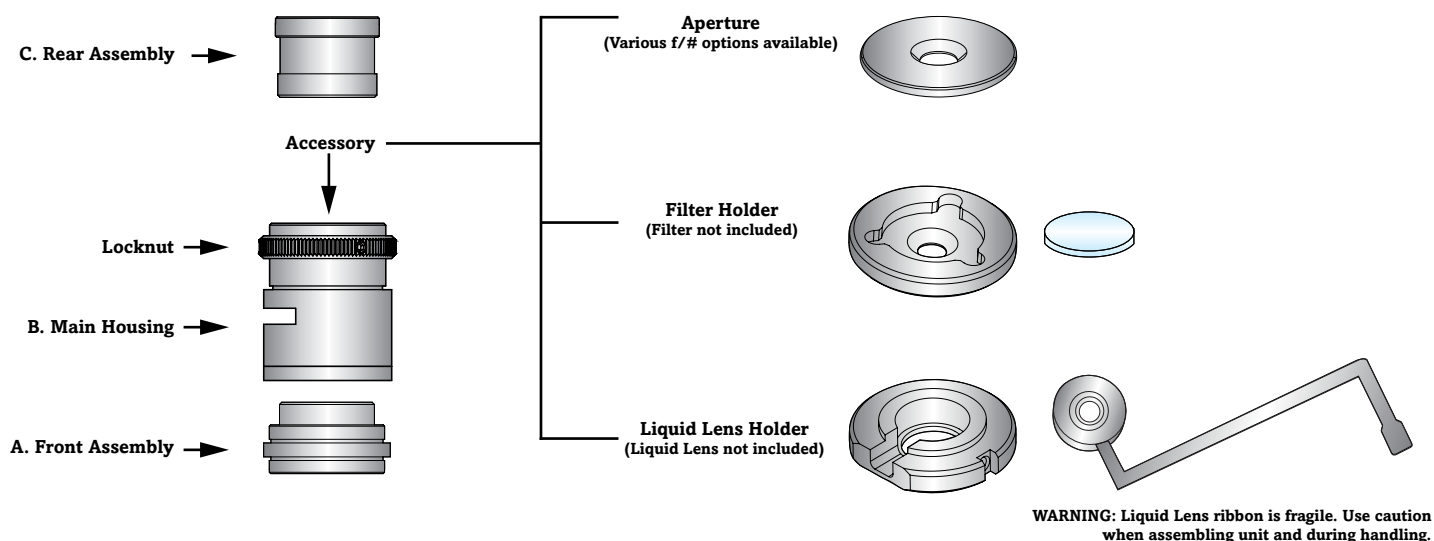

ASSEMBLY INSTRUCTIONS

1. Thread top of Front Assembly into bottom of Main Housing until Front Assembly bottoms out on Main Housing.
2. Select one accessory and follow the appropriate step.
 - i. **Aperture:** Place Aperture into Main Housing from top, with the top of the Aperture directed toward the top of Main Housing, and the bottom of the Aperture directed toward the bottom of Main Housing.
 - ii. **Filter Holder:** Place Filter Holder into Main housing from top, with the 12.9mm inner diameter bore facing up. Tap filter down to make sure it is all the way in. If using a 1.5mm thick filter, add the 0.5mm thick spacer into Filter Holder and tap it down to make sure it is seated in the bore then insert the filter into the bore. When putting the filter into the housing, handle it with a vacuum pick up tool or bamboo tweezers. Make sure the filter is seated.
 - iii. **Liquid Lens Holder:** Place Liquid Lens into Liquid Lens Holder with the top of the Liquid Lens aligned with the top of the Holder, with the ribbon exiting on the flat edge of the Holder. Tighten the set screw on the side until the Liquid Lens is firmly in place.

Thread the ribbon through the slot in Main Housing. Carefully insert Liquid Lens from the top of Main Housing, with the top of the Liquid Lens directed toward the top of Main Housing, and the bottom of the Liquid Lens directed toward the bottom of Main Housing. **WARNING: Liquid Lens ribbon is fragile. Use caution when assembling unit and during handling.**

3. Using spanner wrench, thread the bottom of Rear Assembly into the top of Main Housing until it is flat against the accessory, hand tightening torque or about 2.5-5kgf*cm. If using a Liquid Lens, hold it in place while tightening by inserting a paperclip into one of the holes on flat edge of the Liquid Lens Holder.
4. Adjust Lock Nut position until desired focus is achieved. To set focal position permanently, tighten three socket set screws to secure in place. Do not overtighten screws. Reference tables on Edmund Optics® website for approximate positions. Tighten Nylon Tip Set Screw into place for a focal position that can later be readjusted.
5. Thread entire assembly into C-mount camera from the top of Rear Assembly.

More information can be found at <http://www.edmundoptics.com/cx-series>

Part# 84406610

EDMUND OPTICS® | www.edmundoptics.com

USA: +1-856-547-3488 | EUROPE: +44 (0) 1904 788600
ASIA: +65 6273 6644 | JAPAN: +81-3-3944-6210