

NOTES:

1. SUBSTRATE:
H-K51
2. COATING (APPLY ACROSS CLEAR APERTURE)
S1: NONE
S2: NONE
3. CENTERING: ≤ 30 ARCMIN

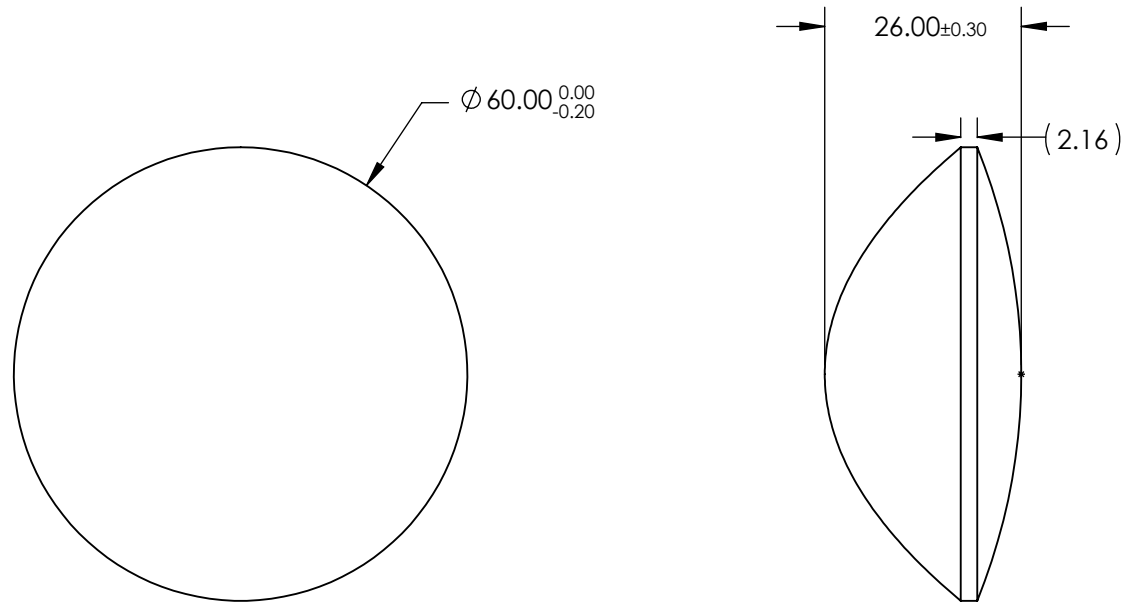

**FOR INFORMATION ONLY:
DO NOT MANUFACTURE
PARTS TO THIS DRAWING**

SPECIFICATIONS SUBJECT TO CHANGE WITHOUT NOTICE
DIMENSIONS ARE FOR REFERENCE ONLY

	S1	S2
SHAPE	CONVEX	CONVEX
SURFACE QUALITY	80-50 (typical)	80-50 (typical)
CLEAR APERTURE	$\varnothing 54.00$	$\varnothing 54.00$
BEVEL	PROTECTED AS NEEDED	PROTECTED AS NEEDED

EFL @ 587.6nm	39.80
BFL @ 587.6nm	25.58



ALL DIMS IN

mm

EO® Edmund Optics®

TITLE

60mm Dia. x 39.8mm FL, Aspheric Condenser Lens

DWG NO

22846

SHEET
1 OF 1